

**LANDSCAPE STUDY**  
Garden of the University House ("Casa Universitarilor")  
(Liebrecht-Filipescu House)  
Dionisie Lupu Street, no. 46, Bucharest



**SHEET P.1.**  
Elements of vertical systematization

**Legend:**



-  Current property boundary
-  Artificially shaped hill

Photo source: authors, 2025

Drawn up by: PhD candidate Landscape Architect Daniela GUJU

PhD candidate Landscape Architect Giovanni LUCA

PhD Landscape Architect Alexandru MEXI,  
specialist certified by the Ministry of Culture, no. 674 S



Date: June 2025

**LANDSCAPE STUDY**  
Garden of the University House ("Casa Universitarilor")  
(Liebrecht-Filipescu House)  
Dionisie Lupu Street, no. 46, Bucharest



**SHEET P.2.**  
Water courses and surfaces

**Legend:**

-  Current property boundary
-  Areas related to water basins

1. Decorative basin with fountain, finished with mosaic, located on the main compositional axis of the garden, dating from the socialist period.
2. Basin located in the immediate vicinity of the greenhouses, most likely built after 1990.

Drawn up by: PhD candidate Landscape Architect Daniela GUJU

PhD candidate Landscape Architect Giovanni LUCA

PhD Landscape Architect Alexandru MEXI,  
specialist certified by the Ministry of Culture, no. 674 S

Date: June 2025



**LANDSCAPE STUDY**  
Garden of the University House ("Casa Universitarilor")  
(Liebrecht-Filipescu House)  
Dionisie Lupu Street, no. 46, Bucharest



**SHEET P.3.**  
Built elements and decorations

**Legend:**

 Current property boundary

- 1 Historic fencing
- 2 Concrete walls
- 3 Prefabricated mesh elements
- 4 Metal gazebo
- 5 Covered terrace
- 6 Hillside rockeries
- 7 Decorative elements
- 8 Decorative element
- 9 Column base
- 10 Column base

Drawn up by: PhD candidate Landscape Architect Daniela GUJU

PhD candidate Landscape Architect Giovani LUCA

PhD Landscape Architect Alexandru MEXI,  
specialist certified by the Ministry of Culture, no. 674 S

Date: June 2025

**LANDSCAPE STUDY**  
Garden of the University House ("Casa Universitarilor")  
(Liebrecht-Filipescu House)  
Dionisie Lupu Street, no. 46, Bucharest

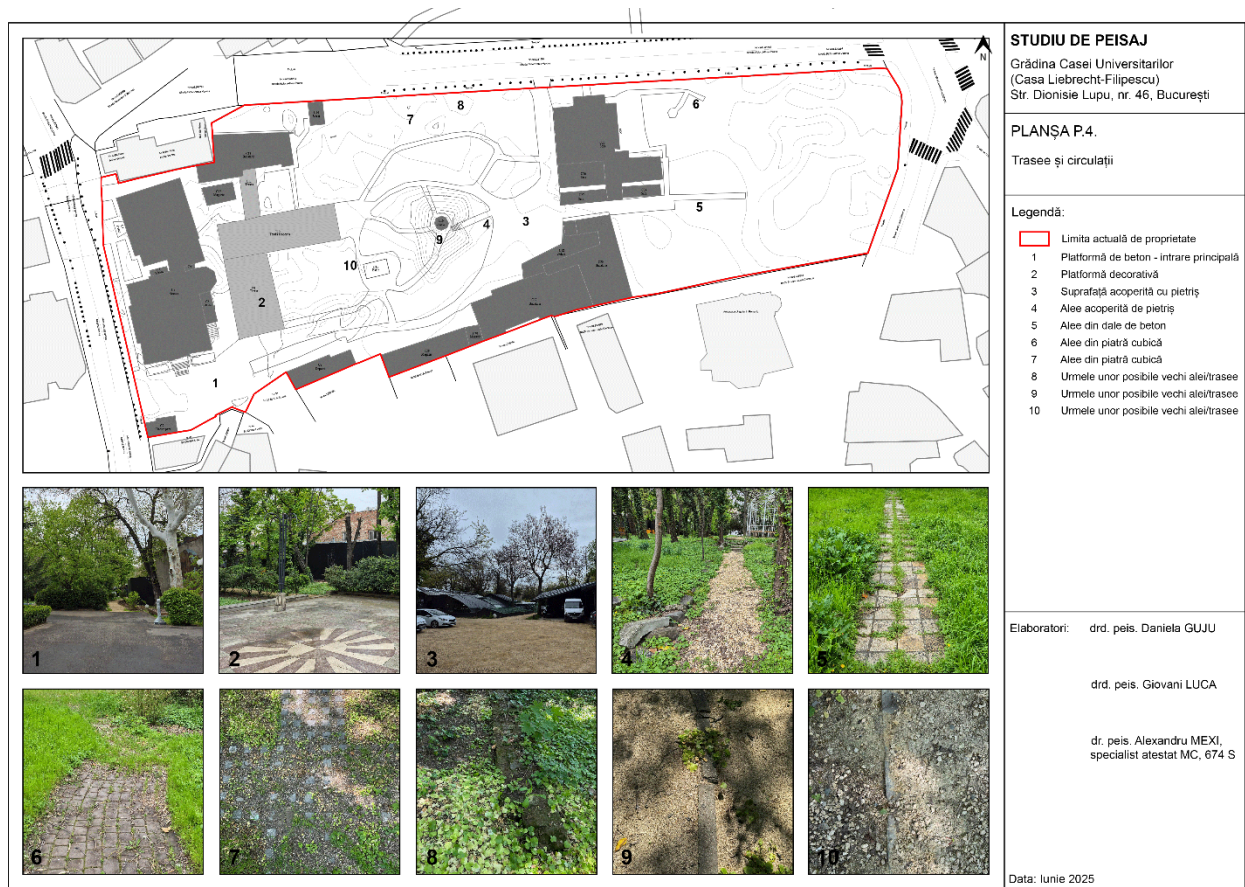

**SHEET P.4.**  
Routes and circulations

**Legend:**

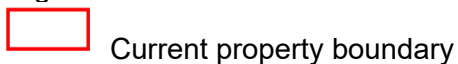

Current property boundary

- 1 Concrete platform – main entrance
- 2 Decorative platform
- 3 Gravel covered surface
- 4 Gravel covered walkway
- 5 Concrete slab walkway
- 6 Cubic stone walkway
- 7 Cubic stone walkway
- 8 Traces of possible old walkways/paths
- 9 Traces of possible old walkways/paths
- 10 Traces of possible old walkways/paths

Drawn up by: PhD candidate Landscape Architect Daniela GUJU

PhD candidate Landscape Architect Giovani LUCA

PhD Landscape Architect Alexandru MEXI,  
specialist certified by the Ministry of Culture, no. 674 S

Date: June 2025



**LANDSCAPE STUDY**  
Garden of the University House ("Casa Universitarilor")  
(Liebrecht-Filipescu House)  
Dionisie Lupu Street, no. 46, Bucharest

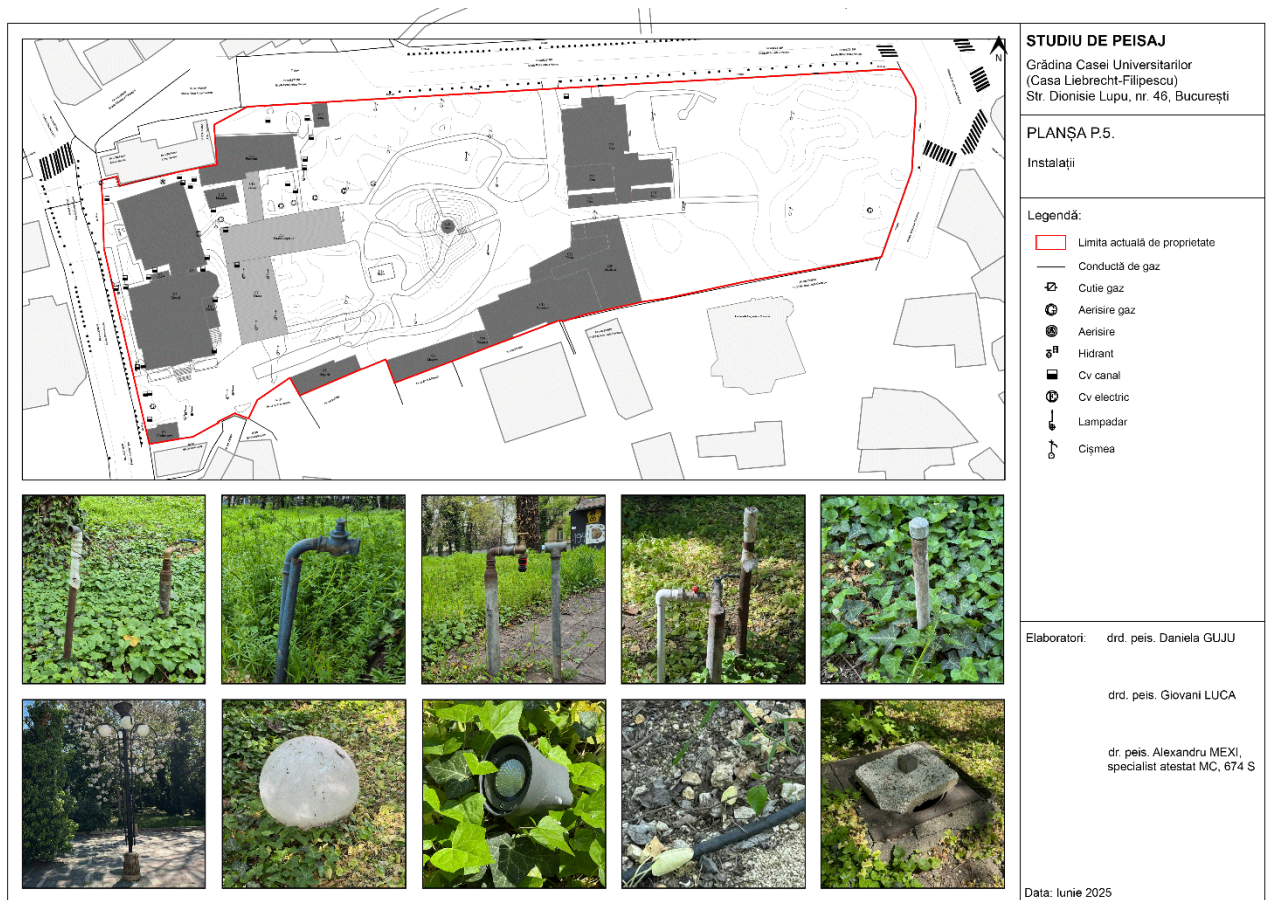

**SHEET P.5.**  
Installations

**Legend:**

- Current property boundary
- Gas pipe
- Gas box
- Gas vent
- Vent
- Hydrant
- Sewer pipe
- Electric pipe
- Lamppost
- Drinking fountain

PhD candidate Landscape Architect Giovani LUCA

PhD Landscape Architect Alexandru MEXI,  
specialist certified by the Ministry of Culture, no. 674 S

Date: June 2025



**LANDSCAPE STUDY**  
Garden of the University House ("Casa Universitarilor")  
(Liebrecht-Filipescu House)  
Dionisie Lupu Street, no. 46, Bucharest

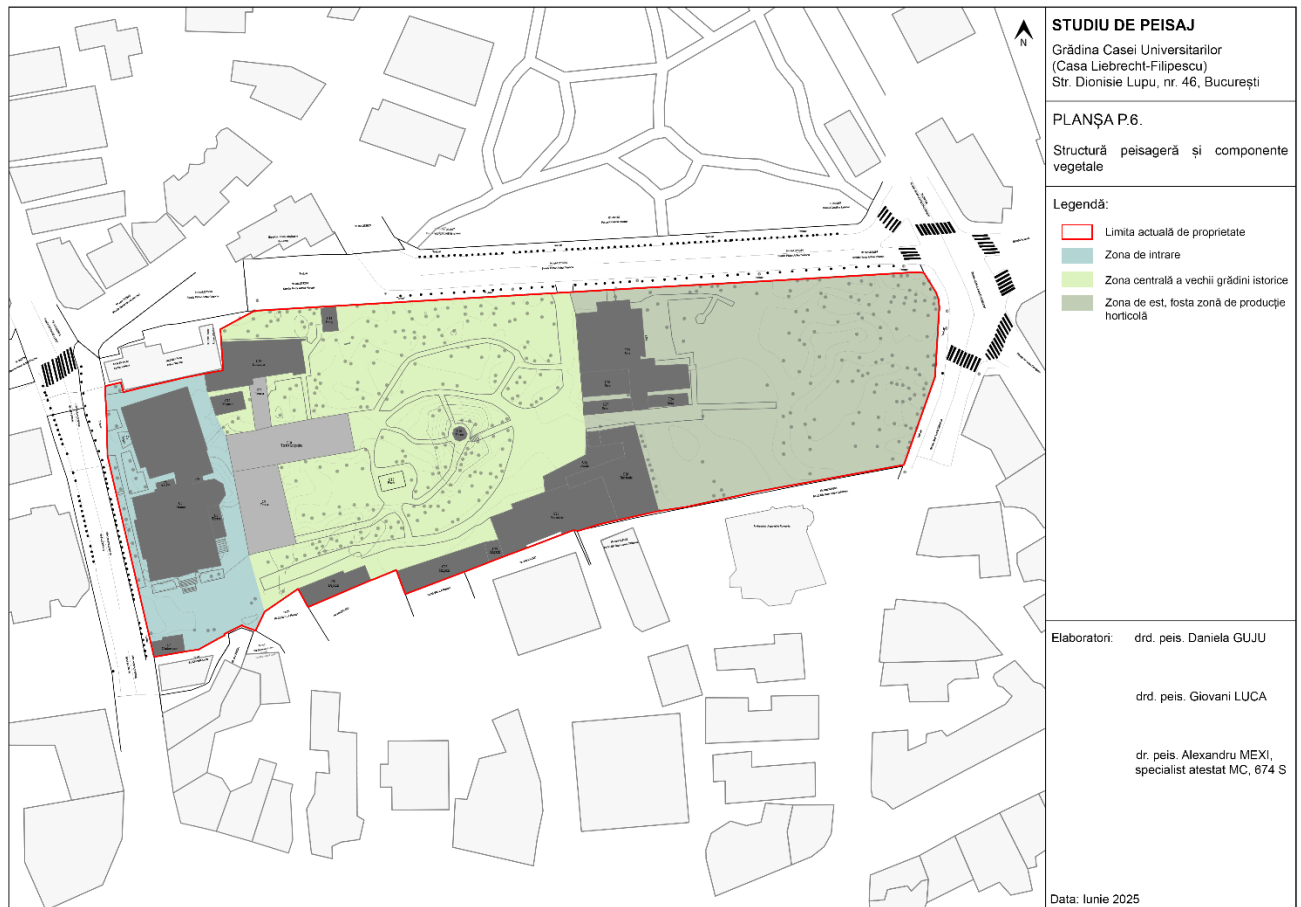

**SHEET P.6.**  
Landscape structure and plant components

**Legend:**

- Current property boundary
- Entrance area
- Central area of the old historic garden
- Eastern area, former horticultural production area

Drawn up by: PhD candidate Landscape Architect Daniela GUJU

PhD candidate Landscape Architect Giovani LUCA

PhD Landscape Architect Alexandru MEXI,  
specialist certified by the Ministry of Culture, no. 674 S

Date: June 2025

**LANDSCAPE STUDY**  
Garden of the University House ("Casa Universitarilor")  
(Liebrecht-Filipescu House)  
Dionisie Lupu Street, no. 46, Bucharest



**SHEET P.7.**  
Tree vegetation survey – species determination

**Legend:**

- Current property boundary
- X.y. Species code
- Tree
- Invasive / potentially invasive species
- Dried specimen



Consecutive no.	Scientific name	CODE	Consecutive no.	Scientific name	CODE
1	<i>Acer campestre</i>	<b>A.c.</b>	15	<i>Paulownia Tomentosa</i>	<b>P.t.</b>
2	<i>Acer negundo</i>	<b>A.n.</b>	16	<i>Picea abies</i>	<b>P.a.</b>
3	<i>Acer platanoides</i>	<b>A.p.</b>	17	<i>Pinus strobus</i>	<b>P.s.</b>
4	<i>Aesculus hippocastanum</i>	<b>A.h.</b>	18	<i>Platanus occidentalis</i>	<b>P.o.</b>
5	<i>Ailanthus altissima</i>	<b>A.a.</b>	19	<i>Populus nigra</i>	<b>P.n.</b>
6	<i>Betula pendula</i>	<b>B.p.</b>	20	<i>Prunus avium</i>	<b>Pr.a.</b>
7	<i>Celtis occidentalis</i>	<b>C.o.</b>	21	<i>Prunus cerasifera</i>	<b>Pr.c.</b>
8	<i>Fraxinus excelsior</i>	<b>F.e.</b>	22	<i>Quercus robur</i>	<b>Q.r.</b>
9	<i>Gleditschia triacanthos</i>	<b>G.t.</b>	23	<i>Robinia pseudoacacia</i>	<b>R.p.</b>
10	<i>Juglans nigra</i>	<b>J.n.</b>	24	<i>Sophora japonica</i>	<b>S.j.</b>
11	<i>Juglans regia</i>	<b>J.r.</b>	25	<i>Taxus baccata</i>	<b>T.b.</b>
12	<i>Koelreuteria paniculata</i>	<b>K.p.</b>	26	<i>Thuja orientalis</i>	<b>T.o.</b>
13	<i>Maclura pomifera</i>	<b>M.p.</b>	27	<i>Tilia platyphyllos</i>	<b>T.p.</b>
14	<i>Morus alba</i>	<b>M.a.</b>	28	<i>Ulmus glabra</i>	<b>U.g.</b>

Drawn up by: PhD candidate Landscape Architect Daniela GUJU

PhD candidate Landscape Architect Giovani LUCA

PhD Landscape Architect Alexandru MEXI,  
specialist certified by the Ministry of Culture, no. 674 S

Date: June 2025

**LANDSCAPE STUDY**  
Garden of the University House ("Casa Universitarilor")  
(Liebrecht-Filipescu House)  
Dionisie Lupu Street, no. 46, Bucharest



**SHEET P.8.**  
Tree vegetation survey – health assessment

- Legend:**
- Current property boundary
  - X.y. Species code
  - Good
  - ⊗ Bad
  - ⊗ Very bad
  - ⊗ Dry specimen



Consecutive no.	Scientific name	CODE	Consecutive no.	Scientific name	CODE
1	<i>Acer campestre</i>	<b>A.c.</b>	15	<i>Paulownia Tomentosa</i>	<b>P.t.</b>
2	<i>Acer negundo</i>	<b>A.n.</b>	16	<i>Picea abies</i>	<b>P.a.</b>
3	<i>Acer platanoides</i>	<b>A.p.</b>	17	<i>Pinus strobus</i>	<b>P.s.</b>
4	<i>Aesculus hippocastanum</i>	<b>A.h.</b>	18	<i>Platanus occidentalis</i>	<b>P.o.</b>
5	<i>Ailanthus altissima</i>	<b>A.a.</b>	19	<i>Populus nigra</i>	<b>P.n.</b>
6	<i>Betula pendula</i>	<b>B.p.</b>	20	<i>Prunus avium</i>	<b>Pr.a.</b>
7	<i>Celtis occidentalis</i>	<b>C.o.</b>	21	<i>Prunus cerasifera</i>	<b>Pr.c.</b>
8	<i>Fraxinus excelsior</i>	<b>F.e.</b>	22	<i>Quercus robur</i>	<b>Q.r.</b>
9	<i>Gleditschia triacanthos</i>	<b>G.t.</b>	23	<i>Robinia pseudoacacia</i>	<b>R.p.</b>
10	<i>Juglans nigra</i>	<b>J.n.</b>	24	<i>Sophora japonica</i>	<b>S.j.</b>
11	<i>Juglans regia</i>	<b>J.r.</b>	25	<i>Taxus baccata</i>	<b>T.b.</b>
12	<i>Koelreuteria paniculata</i>	<b>K.p.</b>	26	<i>Thuja orientalis</i>	<b>T.o.</b>
13	<i>Maclura pomifera</i>	<b>M.p.</b>	27	<i>Tilia platyphyllos</i>	<b>T.p.</b>
14	<i>Morus alba</i>	<b>M.a.</b>	28	<i>Ulmus glabra</i>	<b>U.g.</b>

Drawn up by: PhD candidate Landscape Architect Daniela GUJU

PhD candidate Landscape Architect Giovani LUCA

PhD Landscape Architect Alexandru MEXI,  
specialist certified by the Ministry of Culture, no. 674 S

Date: June 2025

**LANDSCAPE STUDY**  
Garden of the University House ("Casa Universitarilor")  
(Liebrecht-Filipescu House)  
Dionisie Lupu Street, no. 46, Bucharest

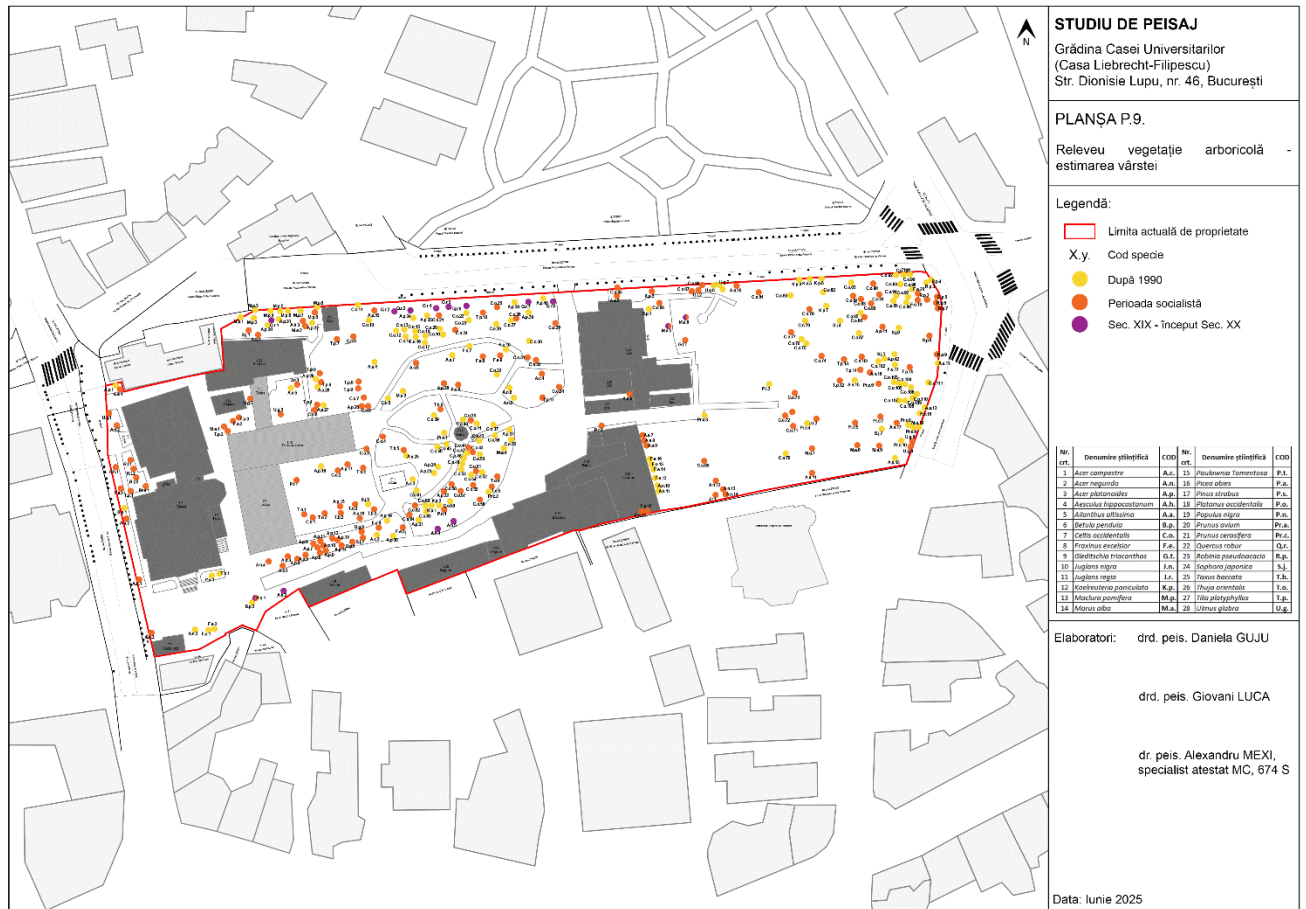

**SHEET P.9.**  
Tree vegetation survey – age estimation

**Legend:**

- [Red line] Current property boundary
- X.y. Species code
- After 1990
- Socialist period
- 19<sup>th</sup> Century – early 20<sup>th</sup> Century



Consecutive no.	Scientific name	CODE	Consecutive no.	Scientific name	CODE
1	<i>Acer campestre</i>	<b>A.c.</b>	15	<i>Paulownia Tomentosa</i>	<b>P.t.</b>
2	<i>Acer negundo</i>	<b>A.n.</b>	16	<i>Picea abies</i>	<b>P.a.</b>
3	<i>Acer platanoides</i>	<b>A.p.</b>	17	<i>Pinus strobus</i>	<b>P.s.</b>
4	<i>Aesculus hippocastanum</i>	<b>A.h.</b>	18	<i>Platanus occidentalis</i>	<b>P.o.</b>
5	<i>Ailanthus altissima</i>	<b>A.a.</b>	19	<i>Populus nigra</i>	<b>P.n.</b>
6	<i>Betula pendula</i>	<b>B.p.</b>	20	<i>Prunus avium</i>	<b>Pr.a.</b>
7	<i>Celtis occidentalis</i>	<b>C.o.</b>	21	<i>Prunus cerasifera</i>	<b>Pr.c.</b>
8	<i>Fraxinus excelsior</i>	<b>F.e.</b>	22	<i>Quercus robur</i>	<b>Q.r.</b>
9	<i>Gleditschia triacanthos</i>	<b>G.t.</b>	23	<i>Robinia pseudoacacia</i>	<b>R.p.</b>
10	<i>Juglans nigra</i>	<b>J.n.</b>	24	<i>Sophora japonica</i>	<b>S.j.</b>
11	<i>Juglans regia</i>	<b>J.r.</b>	25	<i>Taxus baccata</i>	<b>T.b.</b>
12	<i>Koelreuteria paniculata</i>	<b>K.p.</b>	26	<i>Thuja orientalis</i>	<b>T.o.</b>
13	<i>Maclura pomifera</i>	<b>M.p.</b>	27	<i>Tilia platyphyllos</i>	<b>T.p.</b>
14	<i>Morus alba</i>	<b>M.a.</b>	28	<i>Ulmus glabra</i>	<b>U.g.</b>

Drawn up by: PhD candidate Landscape Architect Daniela GUJU

PhD candidate Landscape Architect Giovani LUCA

PhD Landscape Architect Alexandru MEXI,  
specialist certified by the Ministry of Culture, no. 674 S

Date: June 2025

**LANDSCAPE STUDY**  
Garden of the University House ("Casa Universitarilor")  
(Liebrecht-Filipescu House)  
Dionisie Lupu Street, no. 46, Bucharest

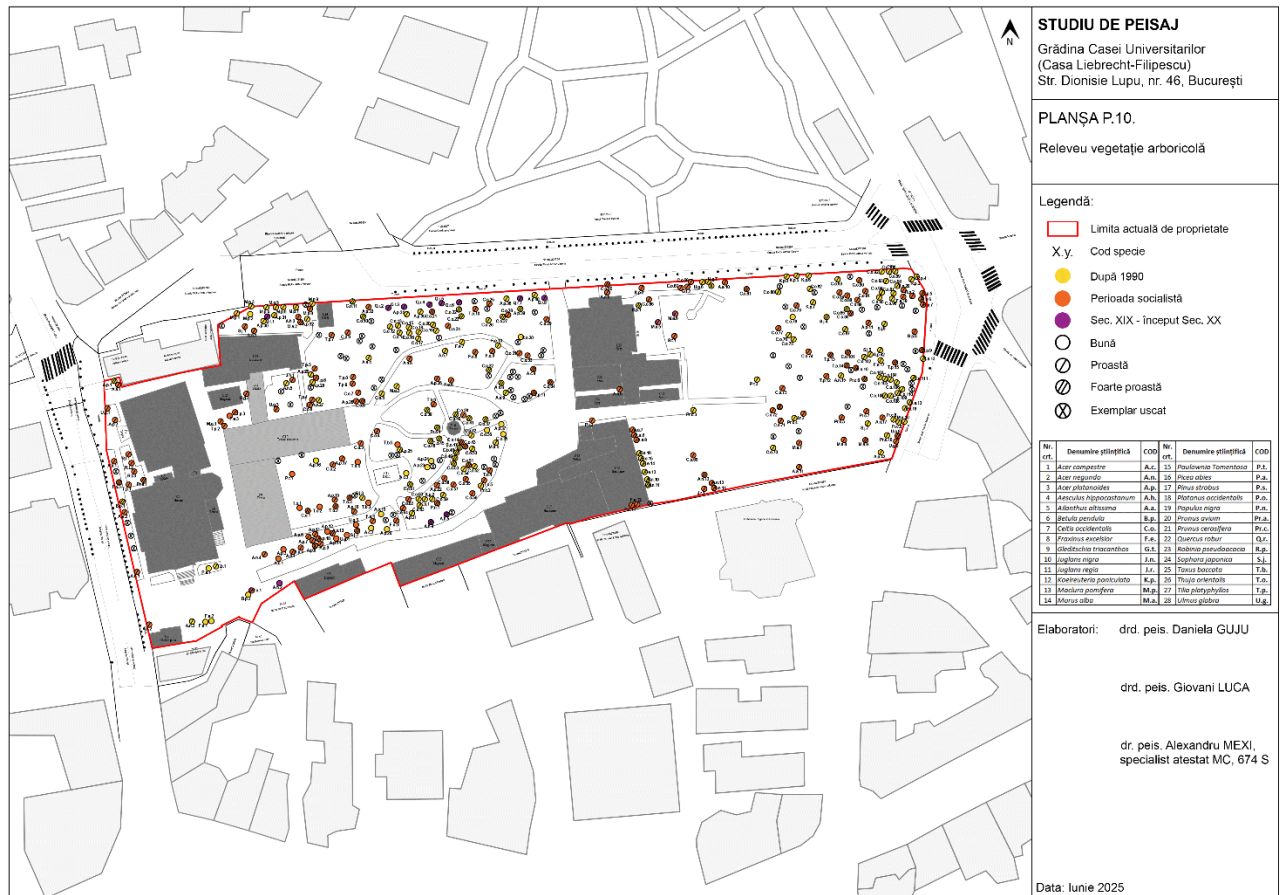

SHEET P.10.  
Tree vegetation survey

**Legend:**

- Current property boundary
- X.y. Species code
- After 1990
- Socialist period
- 19<sup>th</sup> Century – early 20<sup>th</sup> Century
- Good
- Bad
- Very bad
- Dry specimen

Consecutive no.	Scientific name	CODE	Consecutive no.	Scientific name	CODE
1	<i>Acer campestre</i>	<b>A.c.</b>	15	<i>Paulownia Tomentosa</i>	<b>P.t.</b>
2	<i>Acer negundo</i>	<b>A.n.</b>	16	<i>Picea abies</i>	<b>P.a.</b>
3	<i>Acer platanoides</i>	<b>A.p.</b>	17	<i>Pinus strobus</i>	<b>P.s.</b>
4	<i>Aesculus hippocastanum</i>	<b>A.h.</b>	18	<i>Platanus occidentalis</i>	<b>P.o.</b>
5	<i>Ailanthus altissima</i>	<b>A.a.</b>	19	<i>Populus nigra</i>	<b>P.n.</b>
6	<i>Betula pendula</i>	<b>B.p.</b>	20	<i>Prunus avium</i>	<b>Pr.a.</b>
7	<i>Celtis occidentalis</i>	<b>C.o.</b>	21	<i>Prunus cerasifera</i>	<b>Pr.c.</b>
8	<i>Fraxinus excelsior</i>	<b>F.e.</b>	22	<i>Quercus robur</i>	<b>Q.r.</b>
9	<i>Gleditschia triacanthos</i>	<b>G.t.</b>	23	<i>Robinia pseudoacacia</i>	<b>R.p.</b>
10	<i>Juglans nigra</i>	<b>J.n.</b>	24	<i>Sophora japonica</i>	<b>S.j.</b>
11	<i>Juglans regia</i>	<b>J.r.</b>	25	<i>Taxus baccata</i>	<b>T.b.</b>
12	<i>Koelreuteria paniculata</i>	<b>K.p.</b>	26	<i>Thuja orientalis</i>	<b>T.o.</b>
13	<i>Maclura pomifera</i>	<b>M.p.</b>	27	<i>Tilia platyphyllos</i>	<b>T.p.</b>
14	<i>Morus alba</i>	<b>M.a.</b>	28	<i>Ulmus glabra</i>	<b>U.g.</b>

Drawn up by: PhD candidate Landscape Architect Daniela GUJU

PhD candidate Landscape Architect Giovani LUCA

PhD Landscape Architect Alexandru MEXI,  
specialist certified by the Ministry of Culture, no. 674 S

Date: June 2025



**LANDSCAPE STUDY**  
Garden of the University House ("Casa Universitarilor")  
(Liebrecht-Filipescu House)  
Dionisie Lupu Street, no. 46, Bucharest





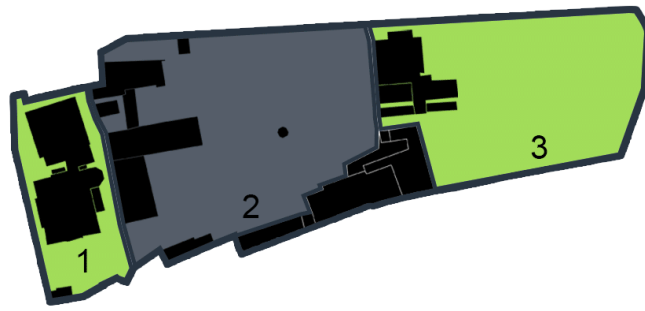

SHEET P.11.  
Cultural assessment

**Legend:**

- Current property boundary
- High cultural value
- Average cultural value
- Low cultural value
- Noxious elements
- Neutral elements
- Plant background
- Historical perspective



-  Plot of land belonging to the University House property
-  Division into three distinct areas
-  High cultural value – area 2
-  Low cultural value – area 1 and 3

Drawn up by: PhD candidate Landscape Architect Daniela GUJU

PhD candidate Landscape Architect Giovani LUCA

PhD Landscape Architect Alexandru MEXI,  
specialist certified by the Ministry of Culture, no. 674 S

Date: June 2025

-Document translated from Romanian-

**LANDSCAPE STUDY**  
Garden of the University House ("Casa Universitarilor")  
(Liebrecht-Filipescu House)  
Dionisie Lupu Street, no. 46, Bucharest



**SHEET I.1.a.**

Analysis of the historical evolution of the plot – 1846 Plan and current survey

Legend:

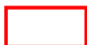
 Current property boundary

Drawn up by: PhD candidate Landscape Architect Daniela GUJU

PhD candidate Landscape Architect Giovani LUCA

PhD Landscape Architect Alexandru MEXI,  
specialist certified by the Ministry of Culture, no. 674 S

Date: June 2025

-Document translated from Romanian-

**LANDSCAPE STUDY**  
Garden of the University House ("Casa Universitarilor")  
(Liebrecht-Filipescu House)  
Dionisie Lupu Street, no. 46, Bucharest



SHEET I.1.b.

Analysis of the historical evolution of the plot – 1846 Plan and current survey

Legend:

[Red dashed line] Current property boundary

Drawn up by: PhD candidate Landscape Architect Daniela GUJU

PhD candidate Landscape Architect Giovanni LUCA

PhD Landscape Architect Alexandru MEXI,  
specialist certified by the Ministry of Culture, no. 674 S

Date: June 2025



-Document translated from Romanian-

## LANDSCAPE STUDY

Garden of the University House ("Casa Universitarilor")  
(Liebrecht-Filipescu House)  
Dionisie Lupu Street, no. 46, Bucharest



### SHEET I.2.a.

Analysis of the historical evolution of the plot – 1852 Plan and current survey

Legend:

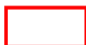
 Current property boundary

Drawn up by: PhD candidate Landscape Architect Daniela GUJU

PhD candidate Landscape Architect Giovanni LUCA

PhD Landscape Architect Alexandru MEXI,  
specialist certified by the Ministry of Culture, no. 674 S

Date: June 2025

-Document translated from Romanian-

**LANDSCAPE STUDY**  
Garden of the University House ("Casa Universitarilor")  
(Liebrecht-Filipescu House)  
Dionisie Lupu Street, no. 46, Bucharest



**SHEET I.2.b.**

Analysis of the historical evolution of the plot – 1852 Plan and current survey

**Legend:**

[Red dashed line] Current property boundary

Drawn up by: PhD candidate Landscape Architect Daniela GUJU

PhD candidate Landscape Architect Giovani LUCA

PhD Landscape Architect Alexandru MEXI,  
specialist certified by the Ministry of Culture, no. 674 S

Date: June 2025

-Document translated from Romanian-

**LANDSCAPE STUDY**  
Garden of the University House ("Casa Universitarilor")  
(Liebrecht-Filipescu House)  
Dionisie Lupu Street, no. 46, Bucharest



**SHEET I.3.**

Analysis of the historical evolution of the plot – 1856 Plan and current survey

Legend:

Current property boundary

Drawn up by: PhD candidate Landscape Architect Daniela GUJU

PhD candidate Landscape Architect Giovanni LUCA

PhD Landscape Architect Alexandru MEXI,  
specialist certified by the Ministry of Culture, no. 674 S

Date: June 2025



-Document translated from Romanian-

**LANDSCAPE STUDY**  
Garden of the University House ("Casa Universitarilor")  
(Liebrecht-Filipescu House)  
Dionisie Lupu Street, no. 46, Bucharest



**SHEET I.4.**

Analysis of the historical evolution of the plot – 1899 Plan and current survey

Legend:

[Red dashed line] Current property boundary

Drawn up by: PhD candidate Landscape Architect Daniela GUJU

PhD candidate Landscape Architect Giovanni LUCA

PhD Landscape Architect Alexandru MEXI,  
specialist certified by the Ministry of Culture, no. 674 S

Date: June 2025

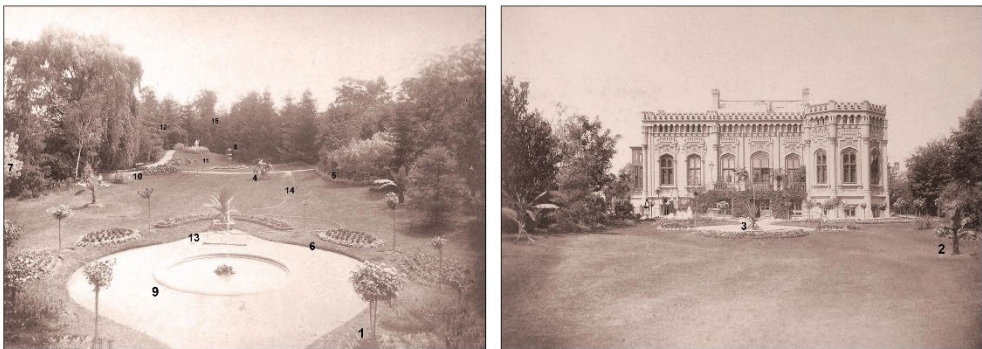
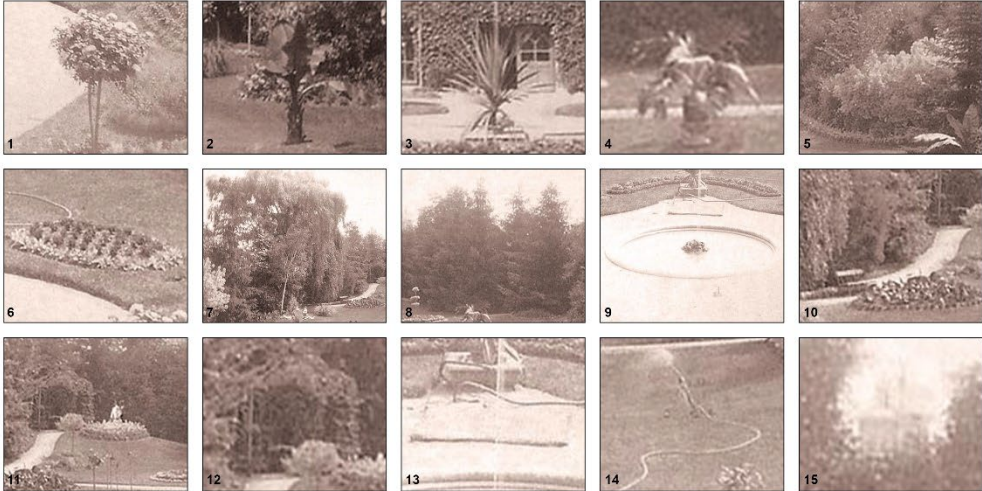

**LANDSCAPE STUDY**  
Garden of the University House ("Casa Universitarilor")  
(Liebrecht-Filipescu House)  
Dionisie Lupu Street, no. 46, Bucharest

		<b>STUDIU DE PEISAJ</b> Grădina Casei Universitarilor (Casa Liebrecht-Filipescu) Str. Dionisie Lupu, nr. 46, București
		<b>PLANȘA I.5.</b> Analiza grădinii istorice prin imagini de epocă  Legendă: 1 Trandafir pe picior 2 Bananier 3 Cordyline sp. / Yucca sp. 4 Palmier 5 Arbusti floriferi 6 Piatra de / arabescuri florale 7 Arbori maturi 8 Plantație de rășinoase 9 Piațetă cu bazin cu havuz 10 Alei din pietriș stabilizat 11 Colină 12 Pergolă / foisor 13 Cămin de vizitare 14 Furtun cu stropitoare 15 Perspectivă deschisă - Biserica Icoanei  <small>Sursa: <a href="https://arhitectura-1906.ro/2017/07/restaurarea-peisagistica-a-gradinii-istorice-liebrecht-filipescu/">https://arhitectura-1906.ro/2017/07/restaurarea-peisagistica-a-gradinii-istorice-liebrecht-filipescu/</a></small>  Elaboratori: drd. peis. Daniela GUJU  drd. peis. Giovanni LUCA  d. peis. Alexandru MEXI, specialist atestat MC, 674 S  Data: Iunie 2025

**SHEET I.5.**  
Analysis of the historical garden through period images

**Legend:**

- 1 Rose on a stem
- 2 Banana tree
- 3 Cordyline sp. / Yucca sp.
- 4 Palm tree
- 5 Flowering shrubs
- 6 Flowerbeds / floral arabesques
- 7 Mature trees
- 8 Softwood plantation
- 9 Square with pool and fountain
- 10 Stabilized gravel paths
- 11 Hill
- 12 Pergola / gazebo
- 13 Visitor's manhole
- 14 Sprinkler hose
- 15 Open perspective – Biserica Icoanei church

Drawn up by: PhD candidate Landscape Architect Daniela GUJU

PhD candidate Landscape Architect Giovanni LUCA

PhD Landscape Architect Alexandru MEXI,  
specialist certified by the Ministry of Culture, no. 674 S

Date: June 2025

-Document translated from Romanian-

## LANDSCAPE STUDY

Garden of the University House ("Casa Universitarilor")  
(Liebrecht-Filipescu House)  
Dionisie Lupu Street, no. 46, Bucharest

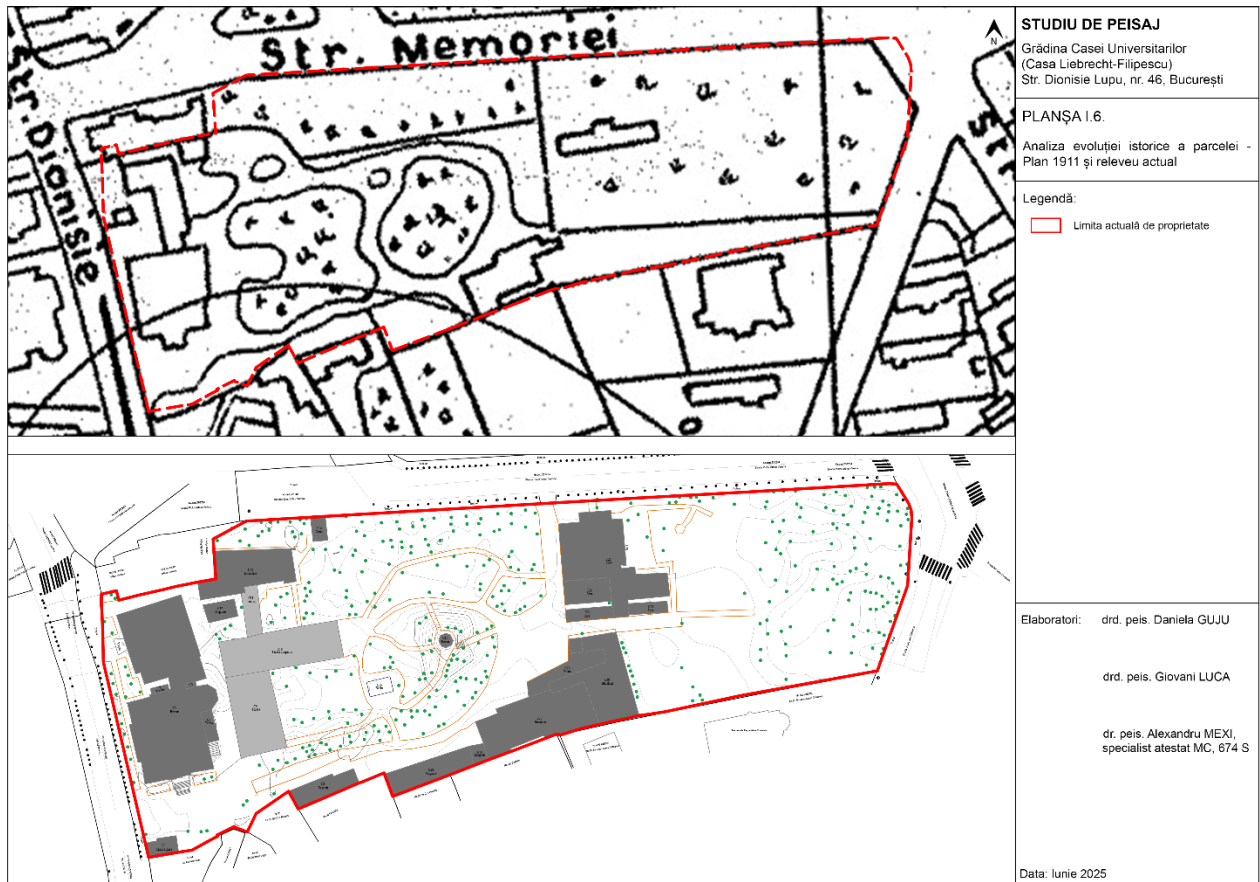

### SHEET I.6.

Analysis of the historical evolution of the plot – 1911 Plan and current survey

Legend:

[Red line] Current property boundary

Drawn up by: PhD candidate Landscape Architect Daniela GUJU

PhD candidate Landscape Architect Giovani LUCA

PhD Landscape Architect Alexandru MEXI,  
specialist certified by the Ministry of Culture, no. 674 S

Date: June 2025

-Document translated from Romanian-

**LANDSCAPE STUDY**  
Garden of the University House ("Casa Universitarilor")  
(Liebrecht-Filipescu House)  
Dionisie Lupu Street, no. 46, Bucharest

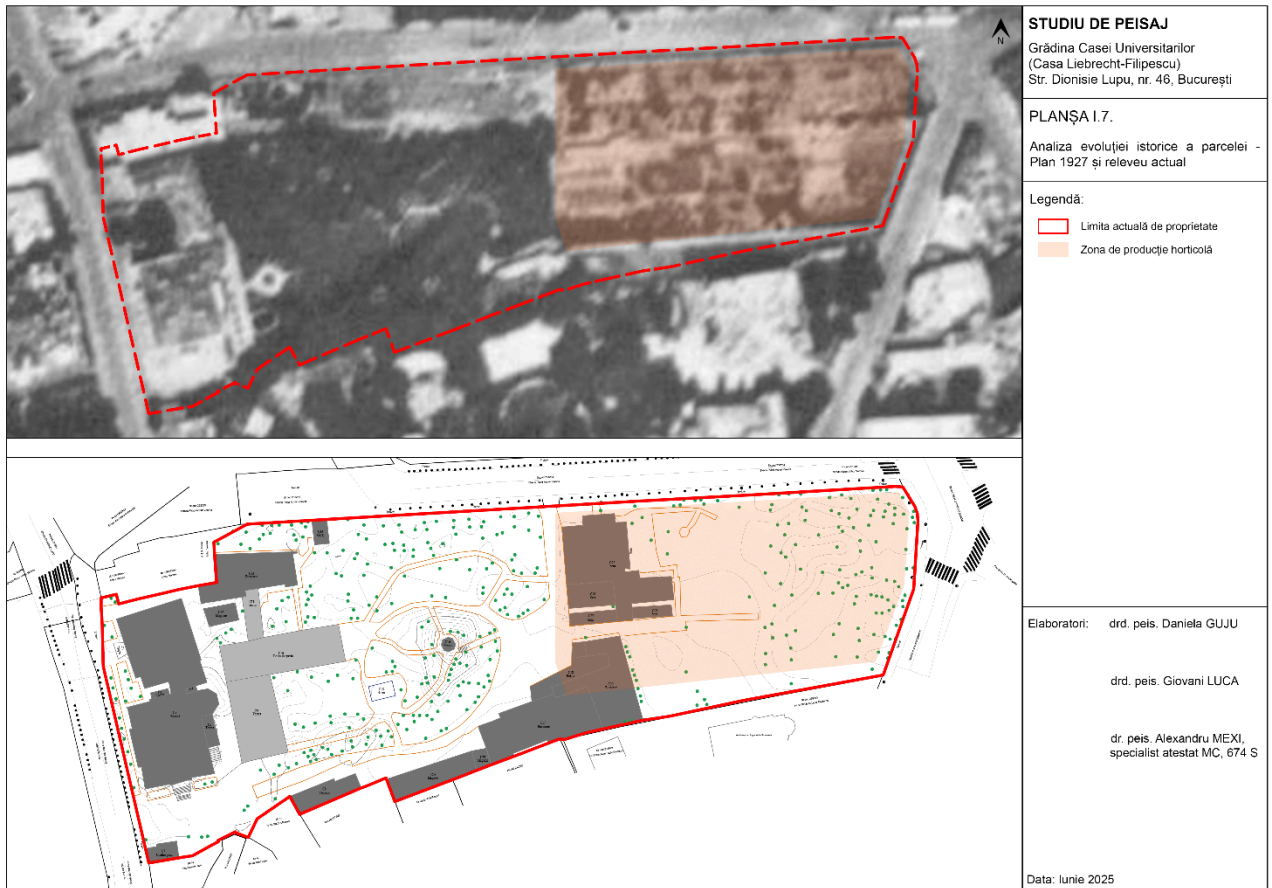

**SHEET I.7.**

Analysis of the historical evolution of the plot – 1927 Plan and current survey

**Legend:**

- [Red dashed line] Current property boundary  
[Orange shaded area] Horticultural production area

Drawn up by: PhD candidate Landscape Architect Daniela GUJU

PhD candidate Landscape Architect Giovanni LUCA

PhD Landscape Architect Alexandru MEXI,  
specialist certified by the Ministry of Culture, no. 674 S

Date: June 2025



-Document translated from Romanian-

**LANDSCAPE STUDY**  
Garden of the University House ("Casa Universitarilor")  
(Liebrecht-Filipescu House)  
Dionisie Lupu Street, no. 46, Bucharest



**SHEET I.8.**

Analysis of the historical evolution of the plot – 1964 Plan and current survey

Legend:



Current property boundary



Area previously occupied by the pool with fountain

Drawn up by: PhD candidate Landscape Architect Daniela GUJU

PhD candidate Landscape Architect Giovani LUCA

PhD Landscape Architect Alexandru MEXI,  
specialist certified by the Ministry of Culture, no. 674 S

Date: June 2025

-Document translated from Romanian-

**LANDSCAPE STUDY**  
Garden of the University House ("Casa Universitarilor")  
(Liebrecht-Filipescu House)  
Dionisie Lupu Street, no. 46, Bucharest



**SHEET I.9.**

Analysis of the historical evolution of the plot – Aerial photos 1966 (top) and 1972 (bottom)

**Legend:**



Current property boundary



The appearance of the 2 terraces and the building body of the current kitchen (left)  
Horticultural production area (right)

Drawn up by: PhD candidate Landscape Architect Daniela GUJU

PhD candidate Landscape Architect Giovanni LUCA

PhD Landscape Architect Alexandru MEXI,  
specialist certified by the Ministry of Culture, no. 674 S

Date: June 2025

**LANDSCAPE STUDY**  
Garden of the University House ("Casa Universitarilor")  
(Liebrecht-Filipescu House)  
Dionisie Lupu Street, no. 46, Bucharest



**SHEET I.10.**

Analysis of the historical evolution of the plot – 1971 Plan and current survey

**Legend:**



Current property boundary



The appearance of the kitchen in the northern area of the plot, the terraces and the gazebo on the hill, as well as the disappearance of the basin with a fountain and the introduction of the decorative basin with mosaic ("the const.[ructed] fountain")

Drawn up by: PhD candidate Landscape Architect Daniela GUJU

PhD candidate Landscape Architect Giovanni LUCA

PhD Landscape Architect Alexandru MEXI,  
specialist certified by the Ministry of Culture, no. 674 S

Date: June 2025

**LANDSCAPE STUDY**  
Garden of the University House ("Casa Universitarilor")  
(Liebrecht-Filipescu House)  
Dionisie Lupu Street, no. 46, Bucharest



**SHEET I.11.**

Analysis of the historical evolution of the plot – 1981 Arrangement/restoration proposal and current survey

Legend:



Current property boundary



Specimens/compositions proposed by Ana Felicia Iliescu in 1981

## LEGEND

	<i>Existing deciduous shrubs</i>
	<i>Existing dwarf shrubs</i>
	<i>Existing coniferous shrubs</i>
	<i>Existing deciduous shrubs</i>
	<i>Existing coniferous shrubs</i>
	<i>Designed deciduous shrubs</i>
	<i>Designed coniferous shrubs</i>
	<i>Lianas</i>
	<i>Existing hedges</i>
	<i>Designed hedges</i>
	<i>Perennial flowers</i>
	<i>Annual and biennial flowers</i>
	<i>Roses</i>
	<i>Lawn replacements</i>

## SHRUBS

*b – Baxus sempervirens*  
(...)

## LIANAS

*P<sub>1</sub> – Parthenocissus tricuspidata*  
(...)

## SOFTWOOD

*j – Juniperus* (...)

## PERENNIAL FLOWERS

*I – Hosta coerulea, (...)*

Designed by: Iliescu Ana

Scale: 1:350

Rearrangement of the green spaces – UNIVERSITY MEN HOUSE – BUCHAREST  
PLANTING PLAN

*Trotuar* – Sidewalk

*Strada* – Street

*Bucatarie* – Kitchen

*Magazie* – Storage space

*Terasa* – Terrace

*Terasa acoperita* – Covered terrace

*Birouri* – Offices

*Cladire paza* – Security building

*Depozit* – Deposit

*Nr. cad.* – Cadastral number

*Ambasada Ungariei in Romania* – Embassy of Hungary in Romania



Drawn up by: PhD candidate Landscape Architect Daniela GUJU

PhD candidate Landscape Architect Giovani LUCA

PhD Landscape Architect Alexandru MEXI,  
specialist certified by the Ministry of Culture, no. 674 S

Date: June 2025

-Document translated from Romanian-

**LANDSCAPE STUDY**  
Garden of the University House ("Casa Universitarilor")  
(Liebrecht-Filipescu House)  
Dionisie Lupu Street, no. 46, Bucharest



**SHEET I.12.**

Analysis of the historical evolution of the plot – Orthophotoplan 2014 (top) and present (bottom)

**Legend:**



Current property boundary



Car park (left)

Former horticultural production area – Decoflora – closed in 2015 (right)

Drawn up by: PhD candidate Landscape Architect Daniela GUJU

PhD candidate Landscape Architect Giovani LUCA

PhD Landscape Architect Alexandru MEXI,  
specialist certified by the Ministry of Culture, no. 674 S

Date: June 2025